

# GALERIE I

JAIME WELSH, *THE INHERITORS*

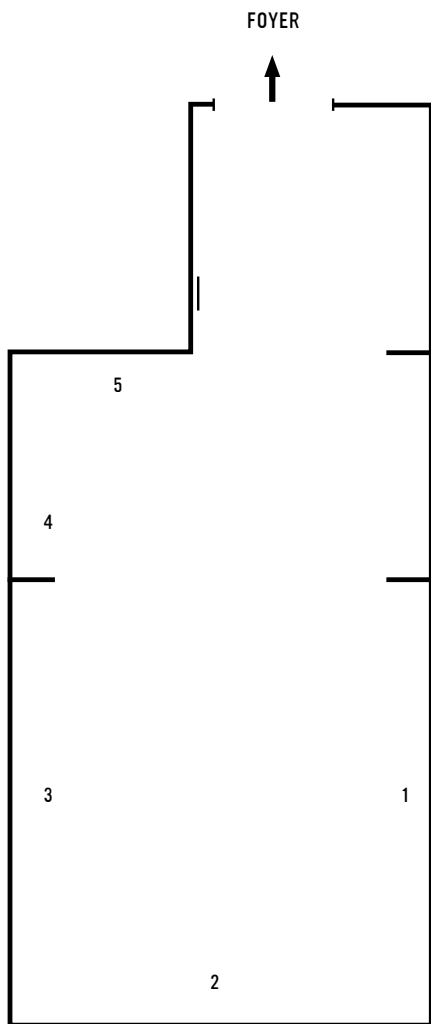

① **Jaime Welsh, *Dust*, 2023**  
Archivalischer Pigmentdruck auf Barytpapier, Museumsglas, Rahmen aus gebeiztem Ahornholz / Archival pigment print on baryta Paper, museum glass, stained maple frame 23 x 30 x 3 cm

② **Jaime Welsh, *Hearth*, 2024**  
Archivalischer Pigmentdruck auf Barytpapier, Museumsglas, Mahagoni-Rahmen / Archival pigment print on baryta Paper, museum glass, mahogany frame 252.53 x 154 x 5 cm

③ **Jaime Welsh, *Swans*, 2024**  
Archivalischer Pigmentdruck auf Barytpapier, Museumsglas, Mahagoni-Rahmen / Archival pigment print on baryta Paper, museum glass, mahogany frame 200.35 x 154 x 5 cm

④ **Jaime Welsh, *The Red Jumper*, 2024**  
Archivalischer Pigmentdruck auf Barytpapier, Museumsglas, Rahmen aus rotem Ahorn / Archival pigment print on baryta Paper, museum glass, red maple frame 32 x 29.5 x 3 cm

⑤ **Jaime Welsh, *Tullius*, 2023**  
Archivalischer Pigmentdruck auf Barytpapier, Museumsglas, Kirschholzrahmen / Archival pigment print on baryta Paper, museum glass, cherry frame 78 x 74 x 3 cm

# GALERIE II

THOMAS LIU LE LANN, ENTERTAIN

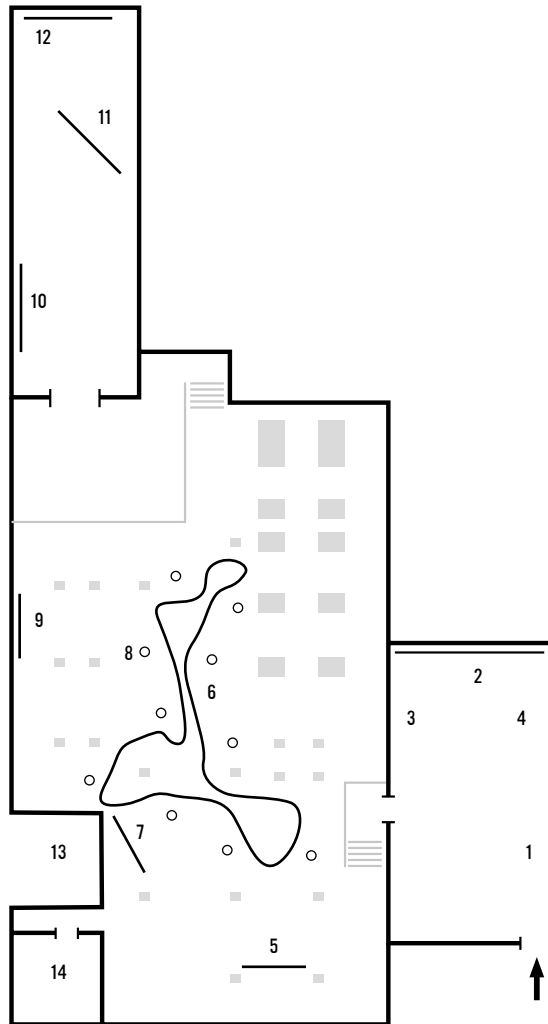

- ① **Thomas Liu Le Lann, *Sweet Teeth #2 (Milo's Braces)*, 2022**

Holz, Lack, Spiegel, geblasenes Glas / Wood, lacquer, mirrors, blown glass  
Courtesy the artist and Xippas

- ② **Thomas Liu Le Lann, *Sweet Teeth #3 (Milo's Braces)*, 2022**

Holz, Lack, Spiegel, geblasenes Glas / Wood, varnish, mirrors, blown glass  
Courtesy the artist and Xippas

- ③ **Thomas Liu Le Lann, *Meaning of Love*, 2022**

Tintenstrahldruck auf Hahnemühle-Baumwollpapier auf Aluminium montiert, lackierter Holzrahmen / Inkjet print on Hahnemühle cotton paper mounted on aluminum, painted wooden frame  
Courtesy Privat Collection, Saint-Genis Pouilly (FR)  
37,8 x 28,8 cm

- ④ **Livia de Goumoëns, Thomas Liu Le Lann, *Come Out to Show Them (Referencing Steve Reich's Come Out, 1966)*, 2024**

Zweikanal-Klangwerk / Two-channel soundpiece  
49 min 18 sec

- ⑤ **Thomas Liu Le Lann, *Level up*, 2024**

Druck auf Polyestergewebe, Stahlösen / Print on polyester fabric, steel eyelets  
300 x 200 cm

- ⑥ **Thomas Liu Le Lann, *I'd rather wear my life inside out*, 2024**

PVC-Plane, verzinkter Stahl, Polypropylen / PVC tarp, galvanized steel, polypropylene  
Variable Maße / Variable dimensions  
(~2800 x 700 x 230 cm)

- ⑦ **Thomas Liu Le Lann, *GYM*, 2024**

HD-Video, Farbe, Loop, Stereoton / HD Video, color, loop, stereo sound  
22 min

With Alfredo Aceto, Grandee Dorji, Théa Giglio, Thomas Liu Le Lann, Anne Minazio, Arttu Palmio, and Clara Roumégoux. Photography by Thomas Liu Le Lann, Alfredo Aceto, Grandee Dorji, and Clara Roumégoux. Choreography by Arttu Palmio. Edited by Hodei Berasategui.

Color grading by Lény Lecointre. Set photography by Théa Giglio. Sound by Livia de Goumoëns and Chih-Yueh Yang (flute).

This project was initiated and supported by the Republic and Canton of Geneva, in collaboration with Présence Suisse, as part of the House of Switzerland in Paris for the 2024 Olympic and Paralympic Games.

- ⑧ **Thomas Liu Le Lann, *Mort le soleil*, 2024**

Installation von 10 Stehlampen, lackierter Stahl, Maglite Taschenlampen, LEDs, Kabel / Installation of 10 floor lamps, painted steel, Maglite torches, LEDs, cables  
Variable Maße / Variable dimensions

- ⑨.1 **Thomas Liu Le Lann, *Big Bamboo (HAT-P-14)*, 2024**

Patinierte Bronze / Patinated bronze  
78 x 87 x 6,5 cm  
Courtesy the artist and Xippas

- ⑨.2 **Thomas Liu Le Lann, *Big Bamboo (HD 102195)*, 2024**

Patinierte Bronze / Patinated bronze  
82 x 83 x 8,5 cm  
Courtesy the artist and Xippas

- ⑨.3 **Thomas Liu Le Lann, *Big Bamboo (π Scorpii Aa)*, 2024**

Patinierte Bronze / Patinated bronze  
92 x 92 x 6,5 cm  
Courtesy the artist and Xippas

## G II d

- ⑩ **Thomas Liu Le Lann, *Here to stay*, 2024**

Holz, Sicherheitsglas, Stahl, Vinyl, Denim, Polyester, Stahl,

synthetische Watte, Buch / Wood, safety glass, steel, vinyl, denim, polyester, steel, synthetic wadding, book  
140 x 148 x 45 cm

- ⑪ **Thomas Liu Le Lann, *Make sense of the world, destroy it*, 2024**

Holz, Sicherheitsglas, Stahl, Vinyl, Denim, Polyester, Stahl, synthetische Watte / Wood, safety glass, steel, vinyl, denim, polyester, steel, synthetic wadding  
135 x 148 x 40 cm

- ⑫ **Thomas Liu Le Lann, *Lovers' Threadscape*, 2024**

Druck auf Polyestergewebe, Acryl, Aluminiumrahmen / Print on polyester fabric, acrylic, aluminum frame  
140 x 250 x 1,9 cm

## G II e

- ⑬ **Thomas Liu Le Lann, *Training part VI*, 2023**

Gebblasenes Glas / Blown glass  
Courtesy Privat Collection, Geneva (CH)

## G II f

- ⑭ **Thomas Liu Le Lann, *Sky Rush*, 2024**

HD-Video, Farbe, Ton / HD video, color, sound  
4 min 30 sec